

Up to 210 bar - 23 lpm

Symbol

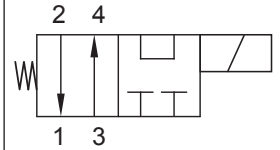

Operation

This is a solenoid operated 4 way 2 position spool valve. It is typically used for controlling a single acting cylinder or hydraulic motor.

Manual override options available.

Features

- Hardened parts for long life.
- Efficient wet-armature construction.
- Cartridges are voltage interchangeable.
- Industry common cavity.
- Unitised, molded coil design.
- Continuous duty rated solenoid.
- Optional coil voltages and terminations.
- Optional "I" Coil: Weatherproof, Thermal, Shock, Immersion Safe.



For higher pressures see HG-S4E.

For higher flows consult factory.

Performance

32 cSt / 38°C.

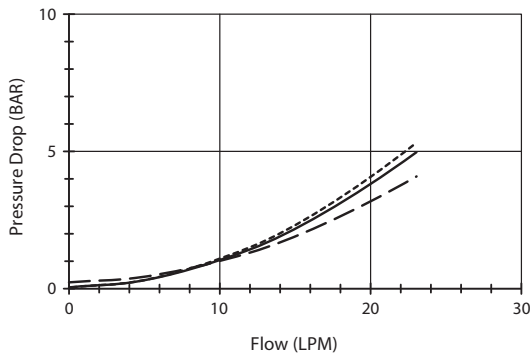

--- Port 2 to 1 (de-eng) Port 3 to 4 (de-eng)
 ——— Port 2 to 4 (eng)

Specifications

Max. Flow (lpm)	23
Max. pressure (bar)	210
Internal Leakage (32 cSt)	82 cc/min at 210 bar
Hydraulic oil	General purpose hydraulic fluid
Viscosity Range	3 to 640 cSt
Filtration	ISO 18/16/13
Operating temp.	-40 to 120°C
Voltage	DC / AC (see coil data page Coil-D)
Cartridge Torque	41 Nm
Coil Nut Torque	5 to 8 Nm
Cavity	DG10-4 (see cavity data page CAV-DG10-4)
Seal Kit	SK-DDGVHDDD
Weight - Cartridge only	0.14 kg
Weight - Cartridge + Coil	0.47 kg
Weight - Cartridge + Coil + Body	0.93 kg (alum) 1.80 kg (steel)

Dimensions
[mm]

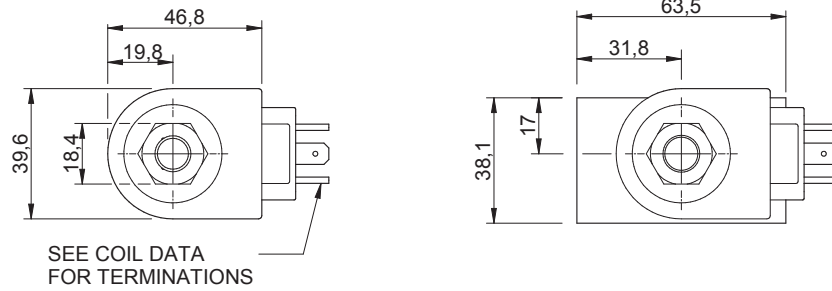

SEE COIL DATA FOR TERMINATIONS

To Override

Detented Version
Pull & Twist

Non-Detented Version
Pull (spring return)

Coils can be fitted in any orientation.

Refer to data sheet Coil-D for coil options.

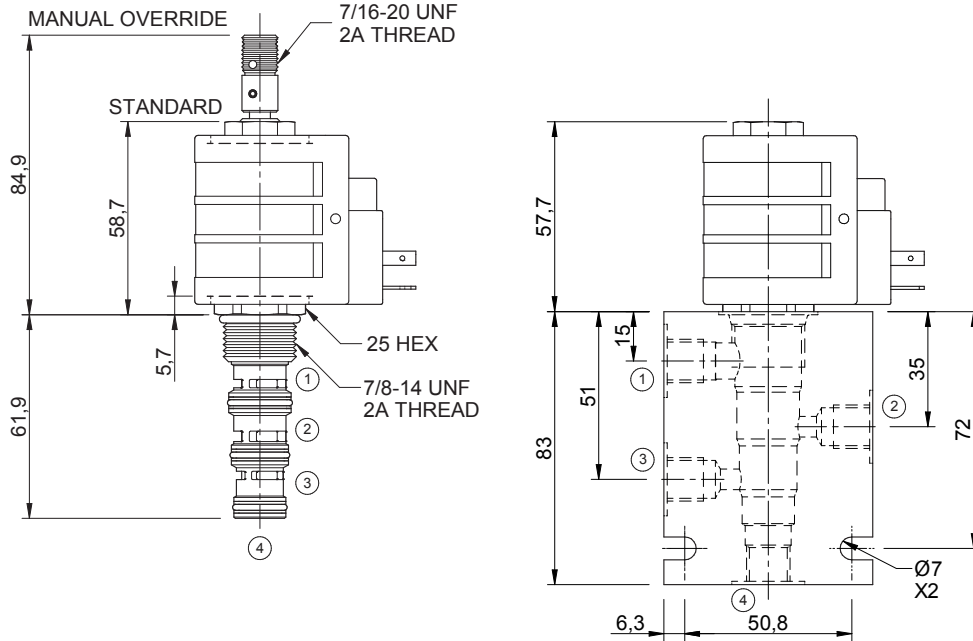

Ordering Code

D-DGS4E — ****** — ****** ****** — ***** ***** *****

Options
00 - Nitrile
V0 - Viton
0M - Nitrile, overr., detent
VM - Viton, overr., detent
B1 - Nitrile, overr., non-detent
V1 - Viton, overr., non-detent

Coil termination
DL - Double lead
DS - Double spade
HC - EN 175301-803*
Options - See page Coil-D
Omit if coil is not required

Voltage
12 - 12 Vdc
24 - 24 Vdc
48 - 48 Vdc
25 - 24 Vac
11 - 110 Vac
23 - 240 Vac
Options - See page Coil-D

Port size (BSP)
A - 1/4"
B - 3/8"
Options - See page B-DDG

No. of ports
4 - 4 ports
Options - See page B-DDG

Body material
A - Aluminium
S - Steel